

Repair Kits

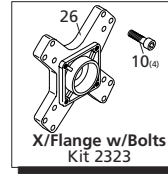
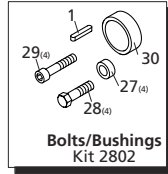
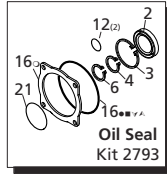

Pos	Code	Description	Qty	Pos	Code	Description	Qty	Legend
1	940770	Key	(8 HP) 1					For ●
2	961800	Seal	(9-10 HP) ●■ 1					For ■
	1941920	Oil seal	▽▲ 1					1690
3	961790	Snap ring	1					Reduction: 1:2
4	320240	Snap ring	1					XMA Series
5	961781	Bearing	1					SXMA Series
6	320240	Snap ring	■▲ 1					RKA Series - Short shaft
7	1389001	Pinion ø1"Z=23	(1750 rpm) ●▽ 1					For ▽
	1389000	Pinion ø1"Z=21	(1450 rpm) ■▲ 1					For ▲
8	1140370	Oil cap / Dipstick	1					1697
9	1320910	Gear box housing	1					Reduction: 1:2
10	881940	Bolt M8x25	(212 in/lbs) 4					XWA Series
11	1980290	Oil sight glass	(70 in/lbs) 1					SXWA Series
12	740290	O-Ring ø14x1.78	2					RKA - Series - Long Shaft
13	1980740	Plug 3/8" G - Brass	(177 in/lbs) 2					
14	160671	Bolt M10x25	(212 in/lbs) 4					
15	880280	Bolt M6x18	(88 in/lbs) 1					
16	1520590	O-Ring ø107.67x1.78	●■▽▲ 1					
17	1940500	Bushing	▽▲ 1					
18	780230	Washer	●■ 1					
19	1321230	Gear Z=45	(1750 rpm) ●▽ 1					
	1320960	Gear Z=47	(1450 rpm) ■▲ 1					
20	1320930	Flange	●■▽▲ 1					
21	640030	O-Ring ø60x2.62	●■▽▲ 1					
24	180432	Bolt M8x20 (XM)	(212 in/lbs) ●■ 4					
	390450	Bolt M8x30	(212 in/lbs) ●■▽▲ 4					
25	1260100	Washer 8x13x0.50	●■▽▲ 4					
26	1320940	Motor flange	1					
27	961770	Spacer	4					
28	961900	Bolt TE 3/8"	4					
29	651000	Bolt TCEI 5/16"	4					
30	1382540	Spacer	●■▽▲ 1					
31	1382530	Pinion seal	1					